

*The*

NORTHERN CRAFTSMAN

*Main Level 908 square footage
Upper Level 920 square footage
Total Square Footage 1828
3 Bedrooms, 2 1/2 Bathrooms
Unfinished Basement 908 square footage
Optional Sun Room 144 square footage*



Popularized at the turn of the 20th century by architect and designer Gustav Stickley, craftsman style is said to be "a house reduced to its simplest form...it's low, broad proportions and absolute lack of ornamentation gives it a character so natural and unaffected that it seems to blend any landscape."

Common features are overhanging eaves, a gabled roof, wide front porches framed by pedestal-like tapered columns. Material often included stone, rough-hewn wood and stucco.

As the Craftsman Approach was concerned with spiritual connectivity with one's surroundings...both natural and manmade...it made sense that the perfect home would compliment the environment and provide a space to cultivate inner peace away from the urban factories where many people worked.

LIFESTYLE CHARACTERISTICS

- Simplified, rustic exterior has just enough detail to create a true Craftsman style.
- Generous gathering area and kitchen layout promotes connectivity of family at mealtime.
- Versatile Study can act as a library, sitting room, home office or whatever your lifestyle requires.
- Awe-inspiring fireplace with earth accents, framed in natural light makes a spectacular gathering place.

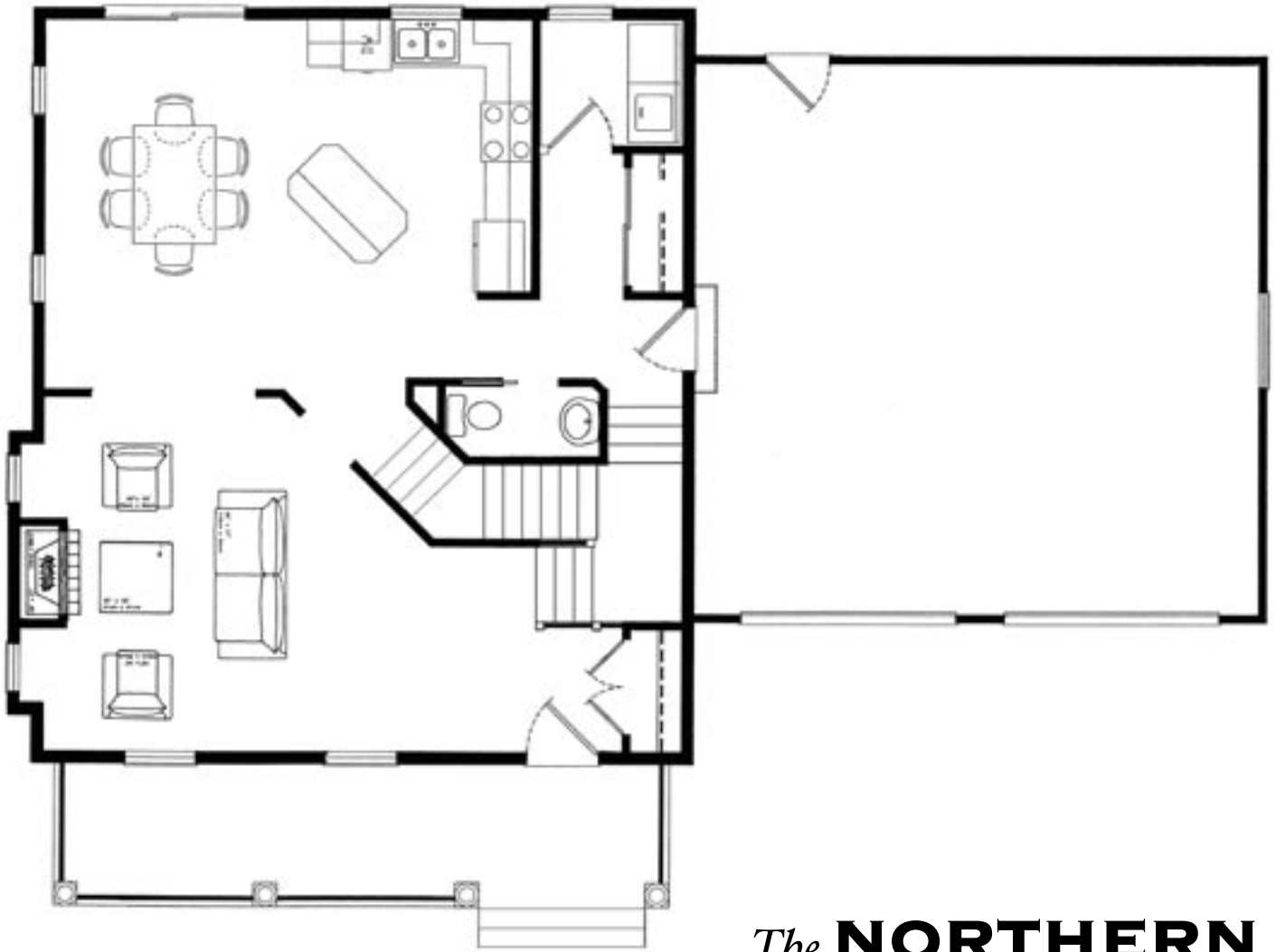

The **NORTHERN
CRAFTSMAN**

